

Happy D.2 Toilet seat and cover # 0064690099

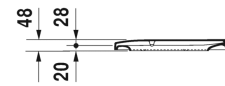
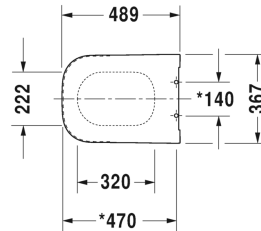

Toilet seat and cover	Dimension	Weight	Order number
hinges stainless steel, elongated, with slow close			
Colors			
00 White			
Variant			
		6 lb	0064690099
Suitable products			
Toilet wall-mounted Duravit Rimless® rimless, washdown model, Durafix included, cUPC listed, 14 3/8" x 24 3/8" Inch	14 3/8" x 24 3/8" Inch		255009
One-Piece toilet syphonic, 12" rough-in, with dual flush piston valve, top flush, vertical outlet, cUPC listed, 1.32/0.92 gpf, 15 3/8" x 28" Inch	15 3/8" x 28" Inch		212101
Two-Piece toilet Duravit Rimless® (without tank), rimless, syphonic, 12" rough-in, vertical outlet, cUPC listed, 1.32/0.92 gpf, 14 3/8" x 28" Inch	14 3/8" x 28" Inch		217401

All drawings contain the necessary measurements which are subject to standard tolerances. They are stated in inch & mm and are non-binding. Exact measurements, in particular for customized installation scenarios, can only be taken from the finished ceramic piece.